

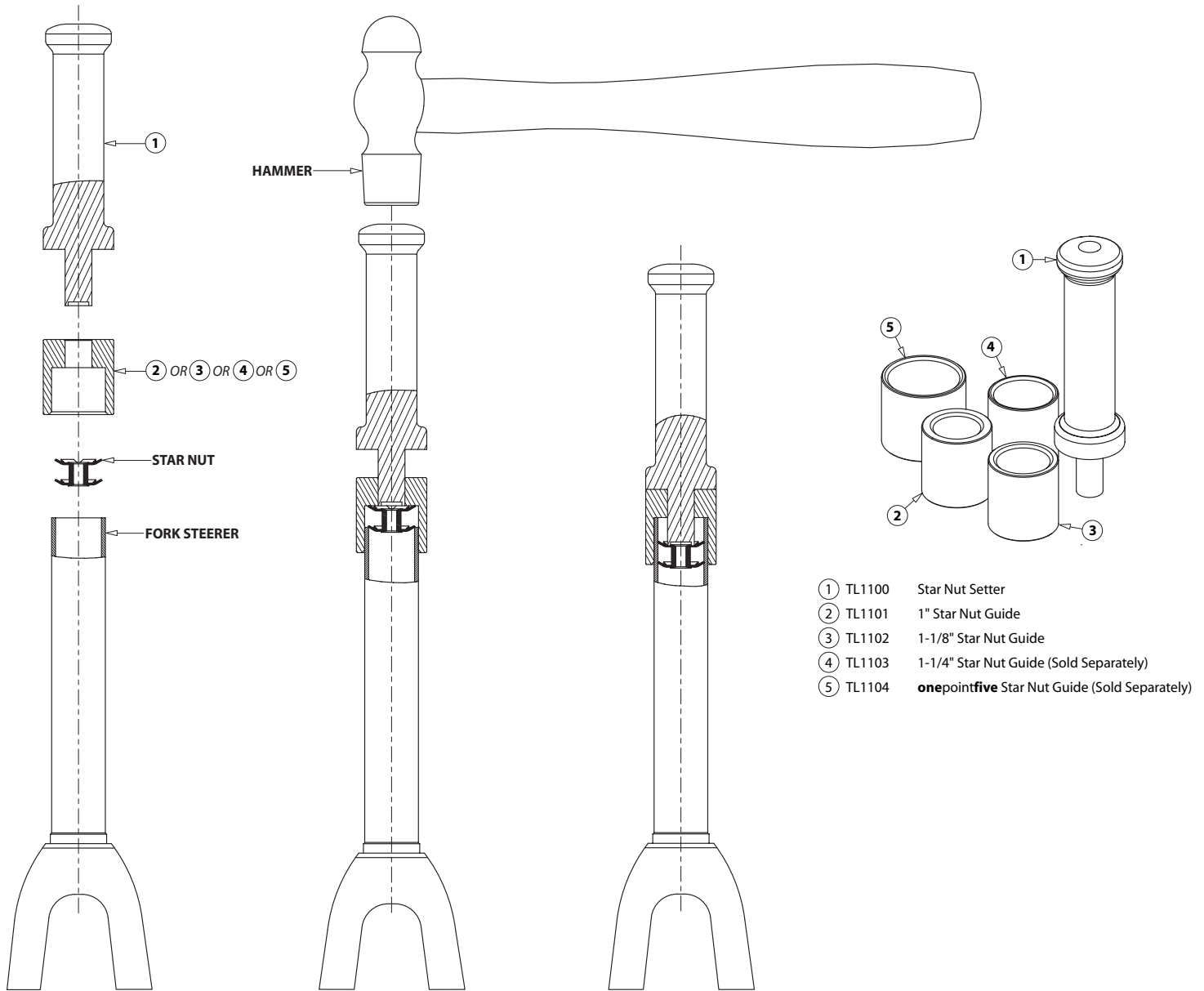

# Star Nut Installation Tool Instructions



**WARNING!** *Safety Glasses should be worn when installing the Star Nut into the steerer!*

*Certain fork models, especially those with carbon steerers, use a special preload mechanism supplied with the fork. When supplied, these should be installed per the instructions of the manufacturer of the fork or preload mechanism. Star Nuts are not intended to be used with Carbon Steerers. Please consult with the fork manufacturer before installing a Star Nut into a carbon steerer.*

## WARRANTY

Cane Creek Cycling Components warrants the SOLOS IS for a period of 10 years from the original date of purchase. Any product that is found to be defective in materials or workmanship will be repaired or replaced at the discretion of Cane Creek. This warranty applies to the original owner only. This warranty does not cover damage or failure resulting from misuse, abuse, alteration, neglect, wear and tear, crash or impact, lack of maintenance or other conditions judged by Cane Creek to be abnormal, excessive, or improper. It is mandatory that a Return Authorization Number (RA#) be obtained by calling Cane Creek before any product is returned. Additionally, a dated Proof of Purchase must accompany the product when returned. (Revised 7.15.2003)

